

|              |  |                          |
|--------------|--|--------------------------|
| 1/4          | BENZIN - Sichelmäher <b>brillencio</b> | <b>brillencio</b>        |
| 2006         | PETROL LAWN MOWER <b>brillencio</b>    | <b>48 BX - Art.62055</b> |
| Rev200606020 | Tondeuses á gazon <b>brillencio</b>    |                          |

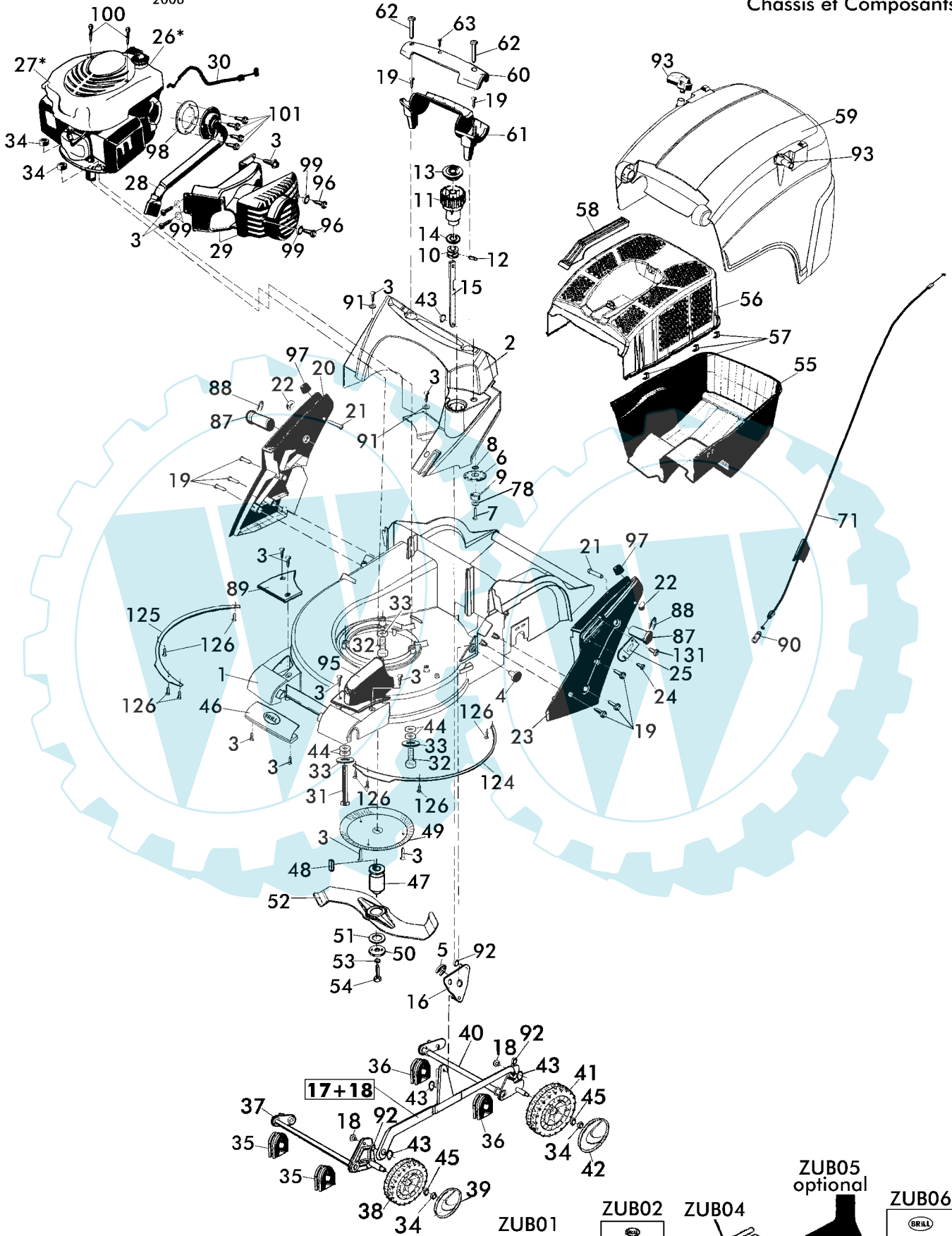

**brillencio**  
**48 BX - Art. 62055**  
2006

Gehäuse & Anbauteile  
Chassis & Components  
Chassis et Composants



\* = BAUTEILE DES MOTORENHHERSTELLERS  
Parts seek assistance from the engine manufacturer's after sales service

ZUB01

ZUB02

ZUB03

ZUB04

ZUB05 optional

ZUB06

| 2/4                          | BENZIN - Sichelmäher <b>brillencio</b> |  | <b>brillencio</b>                   |                        |
|------------------------------|--|--|-------------------------------------|------------------------|
| 2006                         | PETROL LAWN MOWER <b>brillencio</b>    |  | <b>48 BX - Art.62055</b>            |                        |
| Rev200606020                 | Tondeuses á gazon <b>brillencio</b>    |  |                                     |                        |
| Bild Nr.<br>REF.N°<br>POS.N° | BEST.-NR.<br>PART-N°<br>N° d. PIECE    | BEZEICHNUNG                            | DESCRIPTION                         | Anzahl<br>Qty.<br>Qte. |
| 1                            | 13955                                  | Gehäuse 48K/B R kpl. RAL6001           | Chassis 48K/B R cpl. RAL 6001       | 1                      |
| 2                            | 13258                                  | Heckblende 48/51RAL6001                | Rear end bezel 48/51                | 1                      |
| 3                            | 13444                                  | LIB-SCHRAUBE ISO7049-St 4,8*19-C-Torx- | Screw ISO7049-St 4,8*19-C-Torx      | 12                     |
| 4                            | 13761                                  | Lagerbolzen                            | Bolt                                | 1                      |
| 5                            | 06760                                  | S-SCHEIBE 9 DIN6799-ST VERZ            | Circlip 9 DIN6799-ST VERZ           | 1                      |
| 6                            | 10442                                  | SKALENRAD BEDRUCKT                     | Scale wheel                         | 1                      |
| 7                            | 13171                                  | Blechschrabe ISO7049-St 6,3*13-C-      | Self-tapping screw 6,3x13           | 1                      |
| 8                            | 08782                                  | O-RING 12,1*2,7 70 SHORE A,            | O-Ring 12,1*2,7 70 SHORE A,         | 1                      |
| 9                            | 13170                                  | Lager Skala                            | Scale bearing                       | 1                      |
| 10                           | 08606                                  | VERSTELLBOLZEN                         | Adjustment bolt                     | 1                      |
| 11                           | 13252                                  | VERSTELLKNOPF                          | Adjustment knob                     | 1                      |
| 12                           | 08607                                  | ZYLINDERSTIFT 10H8*22 DIN7-ST VERZ     | Parallel pin 10H8*22 DIN7-ST VERZ   | 1                      |
| 13                           | 13169                                  | Deckel bedr.                           | Cover                               | 1                      |
| 14                           | 08610                                  | LAGERSCHEIBE                           | Disk                                | 1                      |
| 15                           | 13067                                  | Zugstange gep RAL7021                  | Pull rod                            | 1                      |
| 16                           | 13069                                  | Schwinge kpl verz.                     | Rocker                              | 1                      |
| 17+18                        | 13974                                  | VERBINDUNGSSTANGE 48 mont.             | Con-rod assy.48                     | 1                      |
| 18                           | 13071                                  | ZUGBOLZEN                              | Tension bolt                        | 2                      |
| 19                           | 13445                                  | SCHRAUBE ISO 7049-St6,3*22-F-Torx-     | Screw ISO 7049-St6,3*22-F-Torx-     | 8                      |
| 20                           | 12974                                  | Holmknoten rts, bearbeitet             | Bar joint right                     | 1                      |
| 21                           | 13155                                  | Bolzen                                 | Bolt                                | 2                      |
| 22                           | 13198                                  | Sperrkappe 6 SBK 1863 vern.            | Arrestor cap                        | 2                      |
| 23                           | 12976                                  | Holmknoten lks                         | Bar joint left                      | 1                      |
| 24                           | 13232                                  | SCHRAUBE M5*12 DIN7500 Torx            | Screw M5*12 DIN7500 Torx            | 1                      |
| 25                           | 13209                                  | Bowdenzughalter                        | Cable connector                     | 1                      |
| 26                           | 13255                                  | V-Motor Quantum X 55                   | V-Motor Quantum X 55                | 1                      |
| 27                           | 13569                                  | Haube XRM 55 RAL2002                   | Motor cover XRM 55 RAL2002          | 1                      |
| 28                           | 13378                                  | Abgasrohr kpl B&S Quantum              | Flue gas pipe assy B&S Quantum      | 1                      |
| 29                           | 13781                                  | Auspuffschutz B&S kpl.                 | Exhaust guard Assy.cpl B&S          | 1                      |
| 30                           | 13834                                  | Bowdenzug Bremse                       | Brake cable                         | 1                      |
| 31                           | 13800                                  | Schraube M8x110 DIN 931-8.8 verz.      | Screw M8x110 DIN 931-8.8 verz       | 1                      |
| 32                           | 13799                                  | SKT-Schraube M8x80 DIN 931-8.8 verz    | Hex.Hd.Screw M8x80 DIN 931-8.8 verz | 2                      |
| 33                           | 07500                                  | SCHEIBE A8,4*25*3 AEHNL,DIN902         | Washer                              | 3                      |
| 34                           | 06684                                  | SKT-MUTTER M 8 DIN985-8 VERZ           | Hex.hd.nut M8 DIN 985-8             | 7                      |
| 35                           | 12944                                  | Lagerschale vorn                       | Front Bearing Seat                  | 2                      |
| 36                           | 09027                                  | LAGERSCHALE HINTEN RAL9005             | Rear Bearing seat                   | 2                      |
| 37                           | 13268                                  | Vorderachse kpl gepulv.RAL7021         | Front axle assy.                    | 1                      |
| 38                           | 13538                                  | LaufRad 195Ø RAL 7021                  | Wheel 195 assy.                     | 2                      |
| 39                           | 12952                                  | Radkappe 195                           | Wheel cap 195                       | 2                      |
| 40                           | 13760                                  | Hinterachse kpl. Gep.                  | Rear axle assy.                     | 1                      |
| 41                           | 13277                                  | LaufRad 220 kpl                        | Wheel 220 Assy.                     | 2                      |
| 42                           | 13280                                  | Radkappe hinten                        | Rear Wheel cap                      | 2                      |
| 43                           | 10574                                  | S-SCHEIBE 6 DIN6799 ROH                | Circlip 6                           | 4                      |
| 44                           | 11249                                  | Tellerfeder                            | Disk spring                         | 6                      |
| 45                           | 06465                                  | SCHEIBE A8,4 DIN125-ST VERZ            | Washer                              | 4                      |
| 46                           | 13281                                  | Griffschale vorn gepulvert             | Grip jacket                         | 1                      |
| 47                           | 15125                                  | Messerflansch                          | Blade flange                        | 1                      |
| 48                           | 02713                                  | KEIL WOODRUFF505 5/32*51               | Woodruff Key                        | 1                      |
| 49                           | 13450                                  | ABDECKSCHEIBE GEP RAL7021              | Barrier                             | 1                      |
| 50                           | 08654                                  | SPANNSCHEIBE GEP RAL2002               | Tension Screw                       | 1                      |
| 51                           | 08740                                  | REIBSCHEIBE , MIT WERKSBEBS,DIN        | Friction disk                       | 1                      |
| 52                           | 13382                                  | Messer 48 gep.RAL 2002                 | Duo-Cutting Blade 48 RAL2002        | 1                      |

| 3/4                          |                                     | BENZIN - Sichelmäher <b>brillencio</b> |  | <b>brillencio</b>        |  |
|------------------------------|-------------------------------------|--|--|--------------------------|--|
| 2006                         |                                     | PETROL LAWN MOWER <b>brillencio</b>    |  | <b>48 BX - Art.62055</b> |  |
| Rev200606020                 |                                     | Tondeuses á gazon <b>brillencio</b>    |  |                          |  |
| Bild Nr.<br>REF.N°<br>POS.N° | BEST.-NR.<br>PART-N°<br>N° d. PIECE | BEZEICHNUNG                            | DESCRIPTION                              | Anzahl<br>Qty.<br>Qte.   |  |
| 53                           | 06460                               | SCHEIBE A10,5 DIN125-ST VERZ           | Washer                                   | 1                        |  |
| 54                           | 13313                               | SKT-SCHRAUBE 3/8"24UNF 2"-8,8          | Tension Screw 3/8"24UNF 2"-8,8           | 1                        |  |
| 55                           | 13288                               | Fangkorb UT                            | Lower Grass Catcher 43                   | 1                        |  |
| 56                           | 13289                               | Fangkorb OT                            | Upper Crass Catcher 43                   | 1                        |  |
| 57                           | 12970                               | Verbindungsklammer FK Silencio         | Clamp                                    | 8                        |  |
| 58                           | 08252                               | TRAGEGRIFF ROT, LOSE                   | Grip                                     | 1                        |  |
| 59                           | 13290                               | Multi-Funktions-Box RAL6001            | Crass Box Cover                          | 1                        |  |
| 60                           | 13340                               | Heckgriff OT gepulvert silber          | Rear grip, Upper part                    | 1                        |  |
| 61                           | 13341                               | Heckgriff UT gepulvert silber          | Rear grip, Lower part                    | 1                        |  |
| 62                           | 13231                               | SCHRAUBE M6*40 DIN7500 Torx,verz.      | Screw                                    | 2                        |  |
| 63                           | 13230                               | SCHRAUBE M4*20 DIN7500 Torx,verz.      | Screw                                    | 1                        |  |
| 71                           | 13942                               | Bowdenzug Bremse Holm                  | Upper Brake Cable 1                      | 1                        |  |
| 78                           | 06843                               | SCHEIBE A5,3 DIN9021 VERZ              | Washer A5,3 DIN9021                      | 1                        |  |
| 87                           | 13460                               | Gelenkbolzen                           | Joint bolt                               | 2                        |  |
| 88                           | 13156                               | S-Scheibe DIN6799-19-SnBz8             | Circlip                                  | 2                        |  |
| 89                           | 13405                               | Abdeckung rts                          | Cover right                              | 1                        |  |
| 90                           | 13248                               | Bowdenzugverbinder                     | Cable connector                          | 1                        |  |
| 91                           | 06843                               | SCHEIBE B5,3 DIN9021 VERZ              | Washer                                   | 2                        |  |
| 92                           | 08399                               | FESCH B8,4*15*0,2 DIN137 VERZ          | Serrated washer                          | 3                        |  |
| 93                           | 12996                               | Mitnehmer                              | Tappet                                   | 2                        |  |
| 94                           | 13935                               | Schraube 4,3x31                        | Screw 4,3x31                             | 2                        |  |
| 95                           | 13723                               | Auspuffschutz Geh.rts.gep.silber       | Muffler guard right                      | 1                        |  |
| 96                           | 13900                               | Schr.M5*12 mit Sich.lack               | Screw M5x12                              | 3                        |  |
| 97                           | 11519                               | Gummifuss schwarz                      | Rubber knob black                        | 2                        |  |
| 98                           | 13305                               | Auspuffdichtung                        | Muffler seal                             | 1                        |  |
| 99                           | 06467                               | Scheibe DIN 125 A5,3                   | Washer DIN 125-A5,3                      | 4                        |  |
| 100                          | 13935                               | Schraube zum Motor 4,3*31              | Screw (Motor) 4,3x31                     | 2                        |  |
| 101                          | 06820                               | LIB-Schraube B4,2x13 DIN 7981 vz       | Screw B4,2x13 DIN 7981                   | 4                        |  |
| 124                          | 13762                               | Versteifungsblech lks 48               | Support plate left 48                    | 1                        |  |
| 125                          | 13763                               | Versteifungsblech rts 48               | Support plate right 48                   | 1                        |  |
| 126                          | 12032                               | ZK-Schraube 3,5x20 KB                  | ZK-screw 3,5x20                          | 8                        |  |
| 131                          | 12723                               | Schraube DIN7500 NE M5*16-ST-Torx      | Screw DIN7500 NE M5*16-ST-Torx           | 1                        |  |
|                              |                                     | <b>ZUBEHOER</b>                        | <b>ACCESSORIES</b>                       |                          |  |
| ZUB01                        | 13350                               | GEBRAUCHSANWEISUNG brillencio          | Instruction for use brillencio           | 1                        |  |
| ZUB02                        | 00563                               | KUNDENDIENSTVERZEICHNIS                | Brill-Service-Booklet                    | 1                        |  |
| ZUB03                        | 06574                               | STECKSCHLÜSSEL DIN659 SW19/21          | Box spanner SW 19/21                     | 1                        |  |
| ZUB04                        | 06591                               | DREHSTIFT 5x100 DIN900 VERZ            | Pin 5x100                                | 1                        |  |
| ZUB05                        | 76012                               | 4-Takt-Motorenöl Flasche (optional)    | Four stroke engine oil bottle (optional) | 1                        |  |
| ZUB06                        | 14989                               | GAW Ergänzung 62055                    | Instruction addendum 62055               | 1                        |  |

|              |  |                   |
|--------------|--|-------------------|
| 4/4          | BENZIN - Sichelmäher <b>brillencio</b> | <b>brillencio</b> |
| 2006         | PETROL LAWN MOWER <b>brillencio</b>    | 48 BX - Art.62055 |
| Rev200606020 | Tondeuses á gazon <b>brillencio</b>    |                   |

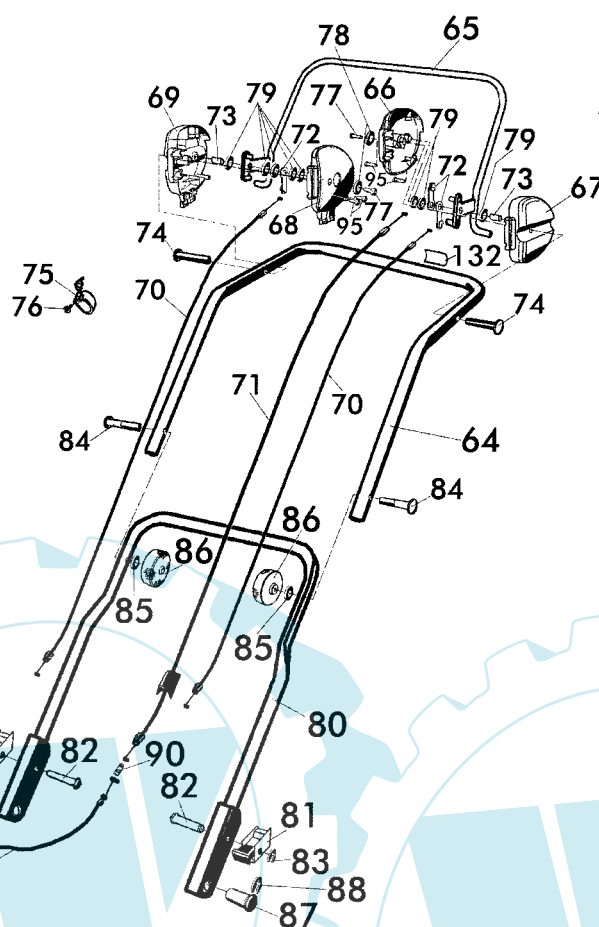

Gestänge,  
Handle Bar,  
Manche

| Bild Nr.<br>REF.N°<br>POS.N° | BEST.-NR.<br>PART-N°<br>N° d. PIECE | BEZEICHNUNG                        | DESCRIPTION                 | Anzahl<br>Qty.<br>Qte. |
|------------------------------|-------------------------------------|------------------------------------|-----------------------------|------------------------|
| 30                           | 13834                               | Bowdenzug Bremse                   | Brake cable                 | 1                      |
| 64                           | 13447                               | GESTÄNGE-OBERTEIL 48               | Upper handle bar 48         | 1                      |
| 65                           | 13454                               | Bremsbügel 48/51 kpl gep.RAL2002   | Brake bail assy. 48/51      | 1                      |
| 66                           | 13315                               | Holmgehäuse lks innen bedruckt     | Bar housing left inboard    | 1                      |
| 67                           | 13228                               | Holm-Gehäuse lks außen             | Bar housing left ambient    | 1                      |
| 68                           | 13226                               | Holm-Gehäuse rts innen             | Bar housing right inboard   | 1                      |
| 69                           | 13227                               | Holm-Gehäuse rts außen             | Bar housing right ambient   | 1                      |
| 70                           | 13941                               | Bowdenzug-Entriegelung             | Cable lock-out release      | 2                      |
| 71                           | 13942                               | Bowdenzug Bremse Holm              | Upper Brake Cable 1         | 1                      |
| 72                           | 13150                               | Bowdenzugmitnehmer                 | Cable tappet                | 3                      |
| 73                           | 13151                               | ZYLINDERSTIFT ISO2338-B-8*24-St    | Pin ISO2338-B-8*24-St*-verz | 2                      |
| 74                           | 13901                               | Isolierhülse                       | Isolation sleeve            | 2                      |
| 75                           | 10953                               | UMLENKHALTER                       | Cable guide                 | 1                      |
| 76                           | 08722                               | LIB-SCHRAUBE BZ 3,5*13 DIN7981 V2A | Screw                       | 1                      |
| 77                           | 13444                               | LIB-Schraube ISO7049-4,8x19 Torx   | Screw ISO7049-4,8x19 Torx   | 2                      |
| 78                           | 06843                               | SCHEIBE A5,3 DIN9021 VERZ          | Washer A5,3 DIN9021         | 2                      |
| 79                           | 06465                               | SCHEIBE A8,4 DIN125-ST VERZ        | Washer                      | 0-2                    |
| 80                           | 13452                               | GESTÄNGE-UNTERTEIL 48 gep.RAL7021  | Lower handle bar 48         | 1                      |
| 81                           | 13510                               | Sperrklinke mont.                  | Catch Assy.                 | 2                      |
| 82                           | 13140                               | Bolzen                             | Bolt                        | 2                      |
| 83                           | 06755                               | S-SCHEIBE 5 DIN6799 VERZ           | Circlip 5                   | 2                      |
| 84                           | 09191                               | FORMSCHRAUBE M8*47 N ZG            | Special form screw          | 2                      |
| 85                           | 06465                               | SCHEIBE A8,4 DIN125-ST VERZ        | Washer                      | 2                      |
| 86                           | 13294                               | Holm-Spanngriff                    | bar tension grip            | 2                      |
| 87                           | 13460                               | Gelenkbolzen                       | Joint bolt                  | 2                      |
| 88                           | 13156                               | S-Scheibe DIN6799-19-SnBz8         | Circlip                     | 2                      |
| 90                           | 13248                               | Bowdenzugverbinder                 | Cable connector             | 1                      |
| 95                           | 12032                               | ZK-Schraube 3,5x20                 | ZK-screw 3,5x20             | 4                      |
| 132                          | 12677                               | Aufkleber Bedienung weiß           | Sticker -Using white-       | 1                      |